



## Gatehouse

180-182 Fazeley Street, Birmingham, B5 5SE



### The Gatehouse

The Gatehouse, which looks towards the canal and private wharf, incorporates five small rooms, ideal for breakout spaces during events. The versatility of The Gatehouse has meant it has provided a special setting for a wide range of activities including fashion shows, Television productions, public lectures, business meetings, conferences, training programmes, away days and many others.

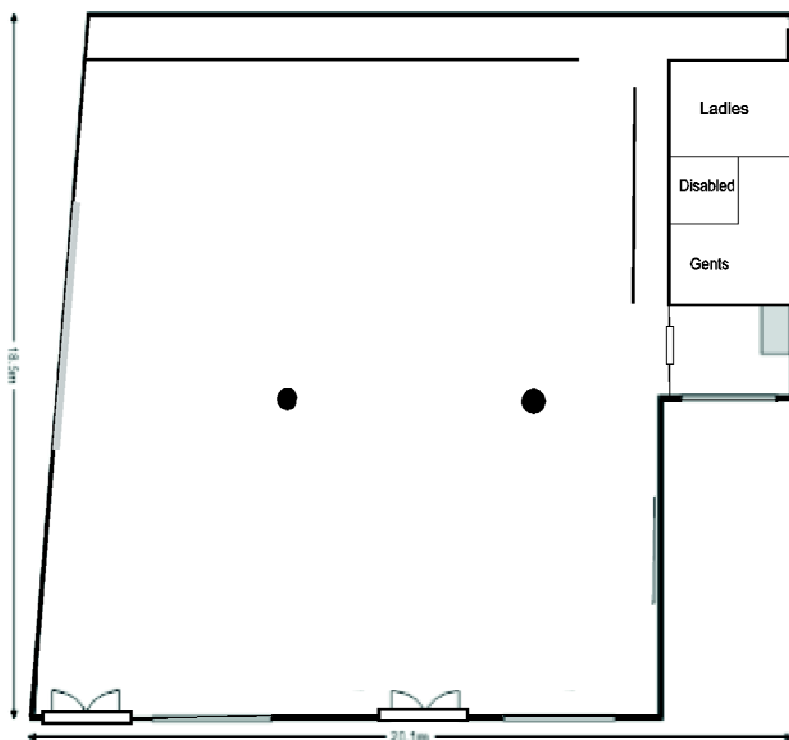

**Key**

	Column		Water Cooler
	Electrical Socket		Heater

Plug socket

**Layout Options**

**Size:** 364 m<sup>2</sup> (3927sqft)

**Capacity:** 35 - 200

	50 people		50 people
	35 people		200 people
			150 people

**Room Facilities**

- Projector screen
- Flipchart
- Projector
- Hearing loop
- Water cooler
- Free wi-fi
- Ceiling Fans
- LED Colour Lighting

**Onsite Facilities**

- Parking
- Cafe (0121 766 7410)
- Reception Services
- Photocopy

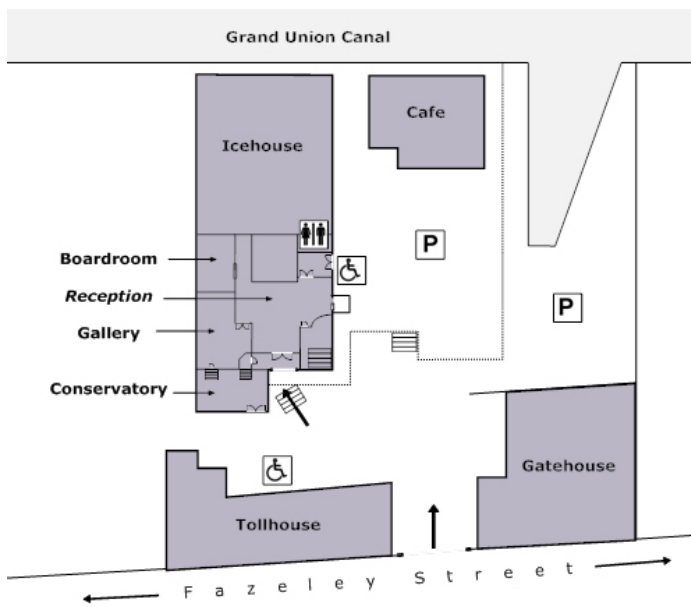

**Location**

The Bond is located within the creative eastside quarter in City Centre Birmingham.

- Under 1 mile from New Street Station
- 4 miles from J6 of the M6
- Under 5 minutes from City Centre
- Under 20 minutes from City Centre

To book or for more information please call The Bond reception team on 0121 766 7400