



Studio

180-182 Fazeley Street, Birmingham, B5 5SE



The Studio

Located behind the main reception on the Ground Floor of The Icehouse, overlooking the canopy and café. This room benefits from natural light, has its own integral kitchenette and comes equipped with a round boardroom table and plasma screen. This room has the ambience for all kinds of meetings, training events and can be used as a break-out room.

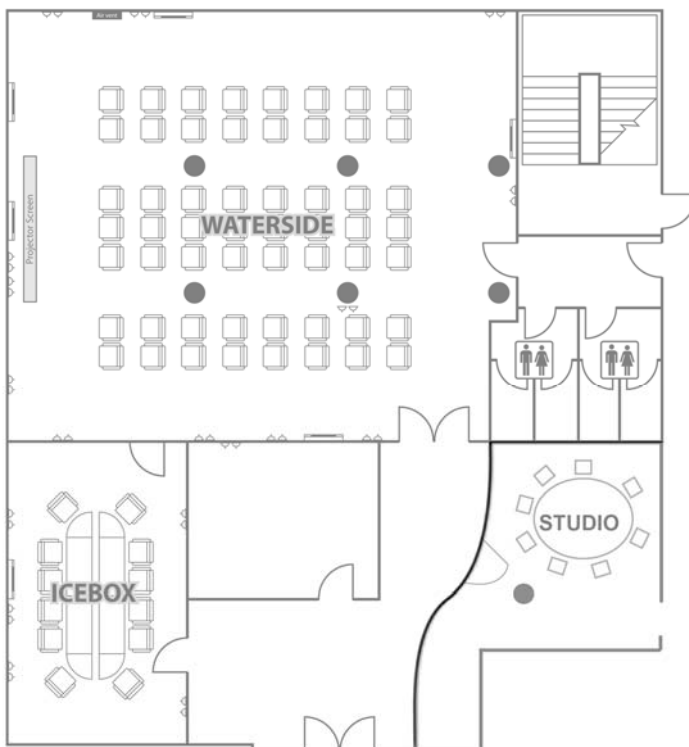

Key



Plug socket

Layout Options & Maximum Capacities

Size: 33 m² (364 sq ft)

Capacity: Up to 100

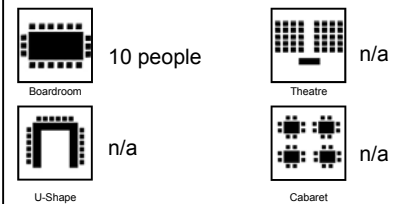

Room Facilities (All inc.)

- Flipchart
- Plasma Screen
- Hearing Loop
- Water Cooler
- Free wi-fi Access
- Self contained WCs

On-site Facilities

- Parking / Taxis
- Reception Services
- Cafe (0121 766 7410)
- Photocopy

Location

The Bond is located within the creative eastside quarter in City Centre Birmingham.

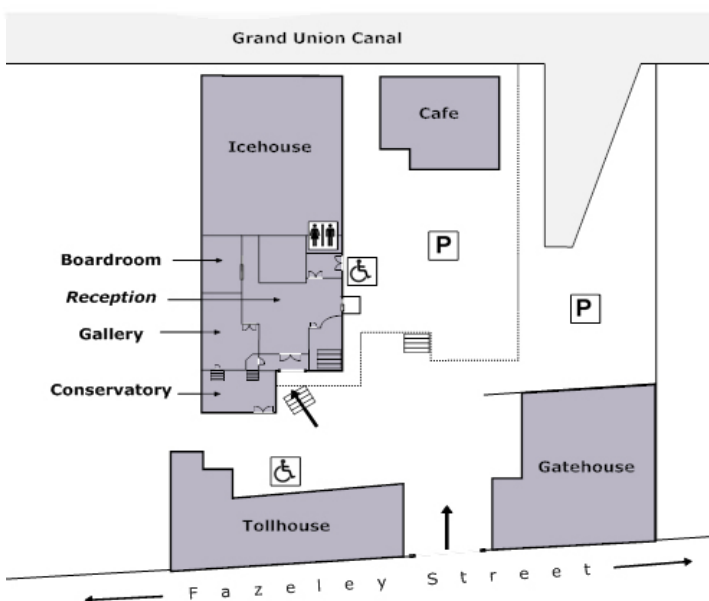
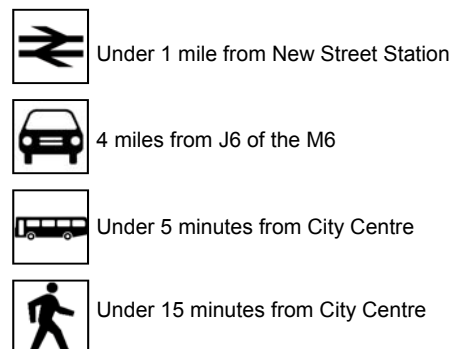

To book or for more information please call The Bond reception team on 0121 766 7400